

in the garage



garage cabinets

- **Built for the garage environment**
- **Powder-coated exterior surfaces**
- **More than 500 cabinet choices**
- **Multiple color choices**
- **Made in the U.S.A.**

Organize. Store. Simplify. AND LOOK



What do you want in your garage?

Room for another car? Places to neatly store things out of sight, within easy reach but easy to find? A clutter-free floor? A workplace for car care, woodworking or gardening? Space to store out-of-season items? Or just a garage that you're not ashamed for your neighbors to see?

From cabinets that organize and neatly store your stuff, to storage walls that let you clear things off your floor, organize it and keep it in easy reach...**garagegear** can help. Whether your garage is large or small, **garagegear** has the solutions for your garage and your needs.

Whatever you want in your garage, start with **garagegear**. With more than 500 cabinet choices in a variety of colors, you can have the garage you've always wanted...clutter free! A usable workbench. Tools and equipment in their places. A floor free of toys and gardening equipment. Last but not least, room for your car. Now you can spend your time doing things... not looking for things.

GREAT!



THE PROBLEM... Clutter is everywhere. Tools and equipment get misplaced. Toys and gardening tools cover the floor. Cleaning is almost impossible. And where do you put a second car?



THE SOLUTION... Get everything off the floor! **Garagegear** storage solutions are wall-hung, getting you organized and freeing limited floor space for other things...like your car.

Garagegear makes it easy

No matter what **garagegear** solution you choose, our goal is to make it easy for you. You decide what you want, and we'll do the rest.

Easy to install

RedLine **garagegear** is sold and installed by factory trained and certified Agents. We'll design a custom solution for you, order the materials and install your new storage system. You can be sure everything will work right...the first time. Nothing for you to do, but put everything in its place and enjoy your regained space.

Easy to use

From the start, you'll find these cabinets are a pleasure to use. From smooth gliding full-extension drawers to wide open-

ing cabinets, its easy to put things in, find them when you want, and take them out again. And the tough finish and worksurfaces are designed to stand up to day to day use and keep working for years.

Easy to maintain

A simple damp cloth will wipe away most common dirt. Stubborn grime, such as grease or oil, can be cleaned with most household cleaners. The tough powder-coated finish and work surfaces can withstand almost any cleaner or solvent. Finally, the off-the-floor design makes it easy to clean beneath and around your cabinets.

Easy to organize

These cabinets are designed to help you organize and keep organized. A

wide variety of drawers, cabinets and tall storage cabinets with customizable interiors make it easy to have the type of storage space you need to fit things. And speciality cabinets for tools and small parts keep everything in its place, easy to find and put away.



We proudly support
our troops around
the world.

The garagegear solution

RedLine **garagegear** cabinets and storage solutions offer the finest garage and workshop organizer systems available. From their wall-hung design to their attractive and extremely durable finish, these storage cabinets set the standard. And unlike big-box store solutions, RedLine **garagegear** is built to last. In fact, our RedLine Storage Cabinets are guaranteed for a lifetime*.

RedLine cabinets are designed to give you years of trouble-free service. We build quality and dependability in before you put anything in them.

Custom designed and built

Garagegear cabinets are designed and built specifically for you, your space and your needs. Upon receipt of your order, we manufacture your cabinets to your exact specifications. No off-the-shelf pre-built solutions. And everything is American made.

Whether you need a work surface for a workshop, gardening or hobbies, or just cabinets for storage, we have you covered. And now you can bring the worksurface to your work with our Rolling Workbench Cart.

And if your space is limited, we have cabinets that fit in as little as 12" of space and require only 7" of clearance to open.

** See Warranty details on the inside back cover of this catalog.*



The garagegear Difference

What separates **garagegear** from its competitors? Here are some of the major reasons **garagegear** is different (and better).

Tough skinned

They say beauty is only skin deep, but the skin on these cabinets is as tough as it is beautiful. The powder-coated finish seals all exterior surfaces – no seams or cracks – and creates a hard durable surface that will withstand cold, heat, humidity, oil, grease, household chemicals, dirt and grime, all found in the garage. And the finishes are as attractive as they are durable, with many exciting decorator colors from which to choose.

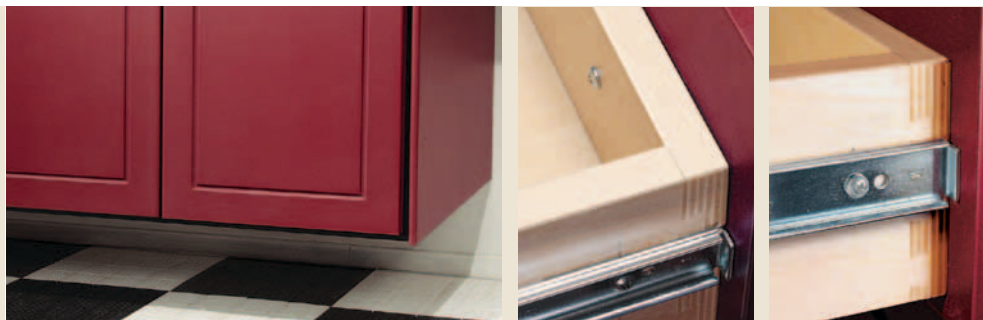

Off-the-floor design

RedLine cabinets hang on the wall to eliminate two of the biggest problems with freestanding units; moisture on the floor, and uneven floors. Unlike other systems, our hang rails are 2" wide for greater strength and stability, while at the same time creating a natural pathway for wiring.

Quality throughout

All drawers are constructed from 9-ply Baltic birch plywood, and feature time-tested dovetail construction for long-life durability. Full-extension drawer slides feature precision ball-bearings for a maintenance-free life and rated at a capacity of 100 pounds.



Engineered for everyday use

First and foremost, **garagegear** has been designed for the user. Wide-opening cabinets and full-extension drawers make access easy. Durable powder coated finishes and tough work surfaces need little or no maintenance. Quality materials and hardware throughout ensure a long trouble-free life. These are cabinets you can count on today and for many years to come.

Built for durability

We built our cabinets to withstand the extremes of temperature and humidity found in the typical garage and still function efficiently. Cabinet exteriors are powder-coated for an attractive, durable finish that outperforms paint or laminate finishes. Work surfaces will stand up to heavy every day use and still look great. Drawer boxes feature superior Baltic birch, dovetail construction and full-extension drawer glides with precision ball bearings for extended use. And heavy duty hardware throughout will last the lifetime of the cabinets.

Personalized storage and workspaces

Whatever your needs and lifestyle—gardening, woodworking, auto shop, sports, or just plain storage—we will custom design a solution just for you. These are cabinets you'll enjoy using every day for a lifetime!

Industry-leading flexibility

Other companies may give you several cabinet choices in a single depth...we give you more than 500 and in multiple depths. And, with a choice of colors, styles and sizes we can create a solution to fit virtually any space and need.

Professional installation

Garagegear is installed by certified professionals. You choose the solution, we do the work.

Industry-leading warranties

All our cabinets carry a Lifetime Warranty*, ensuring years of dependable service. You won't find warranties like these on any competitive products.

** See Warranty details - inside back cover*

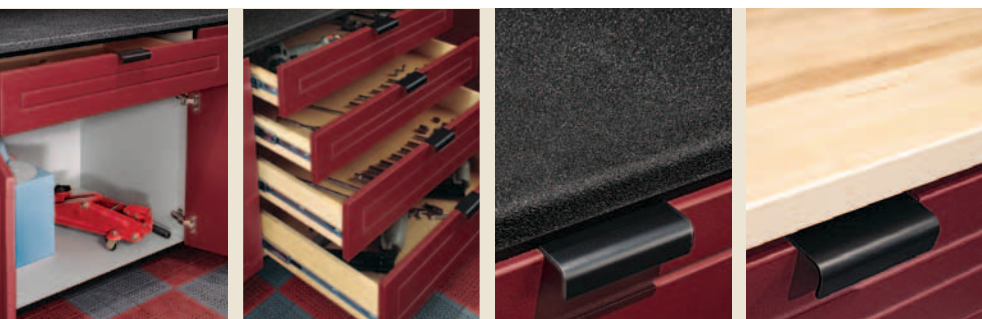

Easy-to-use design

RedLine cabinets were designed from the start to be functional and user-friendly. Wide opening doors and full-extension drawers ensure easy access. Shelves can be adjusted to suit individual needs. All surfaces can be easily cleaned. These cabinets will be a pleasure to use for years to come.

Work surfaces that can take a beating

Our black urethane work surfaces are coated with the same material used on truck beds, creating a water-tight, chemical-resistant finish.

Butcher block tops are constructed of 1-1/4" hardwood maple with a clear protective coating. This beautiful wood will withstand heavy use for years to come.

Garagegear Cabinets and Components

Garagegear cabinets were designed and built specially for the garage environment. From seamless finishes to heavy-duty hardware, these cabinets offer features competitors can't touch:

- Powder-coated exterior surfaces – resists humidity, chipping, denting, peeling or rusting
- More than 500 cabinet choices
- Multiple color choices
- 9-ply Baltic birch plywood drawers – won't warp or disintegrate
- Drawers feature superior dovetail construction for strength
- Full-extension drawer slides with 100 lb. static and dynamic rating
- 6-way adjustable door hinges
- Anodized aluminum or stainless steel handles – resist rust and corrosion
- Powder-coated steel hang rail – resists corrosion
- Cabinets are available in 12", 16" or 24" depths
- Single and bi-fold doors available for tight spaces and limited clearance
- Lifetime warranty - details on page 11

Cabinet Finishes

Garagegear cabinets feature powder-coated finishes in more color choices than any other manufacturer. These choices are possible because we manufacture the cabinets and powder-coat them ourselves.



Upper Cabinets
Double and single door units – with adjustable shelf, in two heights.



Lower Cabinet
Single and double door designs, with or without drawer.



Trash Pullout
Full extension drawer holds 13 qt. trash can.



Storage Cabinet
Adjustable shelves with optional pullout shelf. 5 shelves standard.



Bi-fold Doors
Bi-fold doors require only 7" to open. Great for limited space.



Corner Cabinet
Wrap your cabinets around the corner. Tall, upper and lower cabinets.

Powder Coated Finishes

Only RedLine powder-coats all cabinet exterior surfaces, creating a finish that outperforms plastic, paint or laminate, and resists chipping, denting, peeling or warping. Powder coated MDF is the perfect material for the garage environment.

We use MDF for doors, drawer fronts and panels because of its strength and smooth, uniform surface. We spray all surfaces with an electrostatically-charged powdered mixture and then heat the piece, causing the powder to gel and flow, bonding to the surface and completely sealing the piece. The resulting finish is as attractive as it is durable.

And the process is environmentally friendly, containing no heavy metals, solvents or VOCs.



Classic Burgundy
Stippled matte finish



Platinum
Stippled matte finish



New Burgundy
Textured gloss finish



Sandstone
Light textured semi-gloss



Earthstone
Light textured semi-gloss



Storage Bin Pullout
Dual sided with 32 removable plastic bins.



Drawer Cabinet
Full extension drawers with 50 lb. capacity each. 3 to 7 drawer units.



Island Workbench
Available in multiple sizes and configurations, with legs or casters. See page 9 for details.



1 1/4" Work Surfaces
Beautiful and durable Maple Butcher Block or industrial-strength Black Urethane.



Garage Closet
64" wide open unit with folding doors. Great for storing tall or large items. Shown with optional slatwall.



Sturdy Drawer Boxes
9-ply Baltic birch with dovetail construction. Full-extension ball bearing drawer slides.

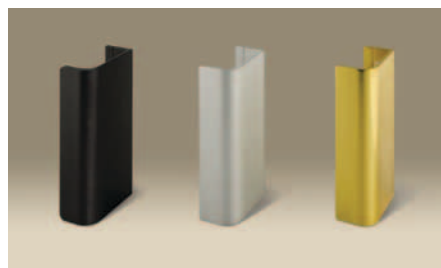

Door Handles
Available in 10" stainless steel, bar-style handles (top) or anodized aluminum in choice of black, satin nickel or brass finishes (below).



Heavy-duty Hardware
6-way adjustable hinges, castors rated for 750 lb. and great for the garage.

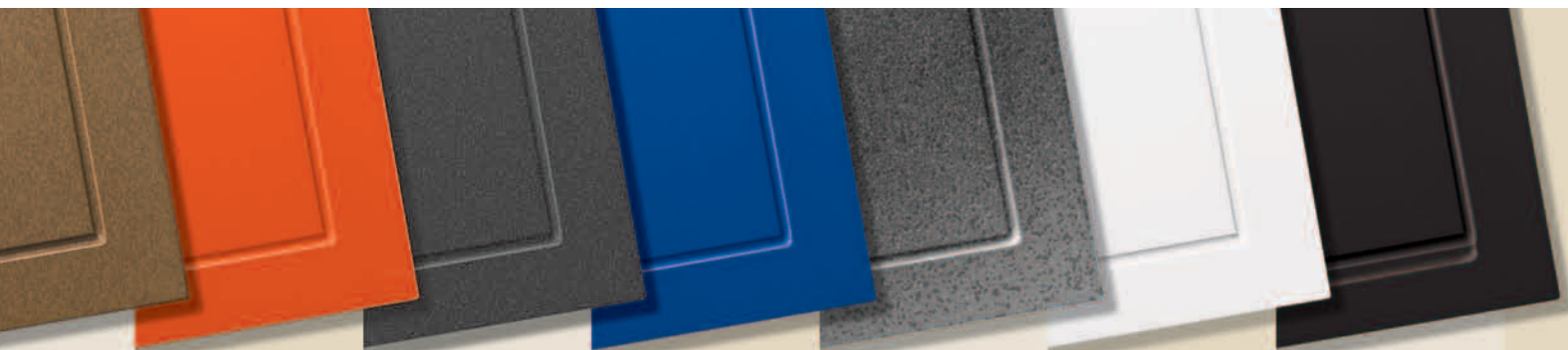

Stone
Textured semi-gloss



Mid-life Crisis Orange
Textured gloss



Pewter
Textured gloss finish



Royal Blue
Textured gloss finish



Silver Vein
Textured gloss finish



White
Stippled matte finish



Black
Textured gloss finish

Actual colors may vary from those shown here. Colors are subject to change. See your Agent for current samples.

Cabinet Choices



Garagegear offers more cabinet styles and sizes than any other garage cabinet manufacturer. With more than 500 cabinet variations and multiple colors from which to choose, you can find a perfect fit for your space.

UPPERS

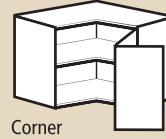
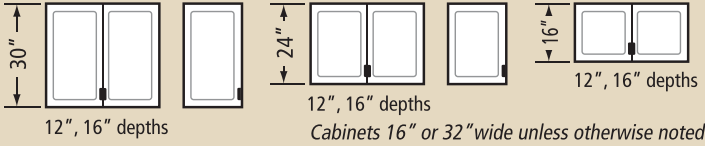

LOWER CABINETS

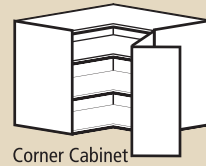
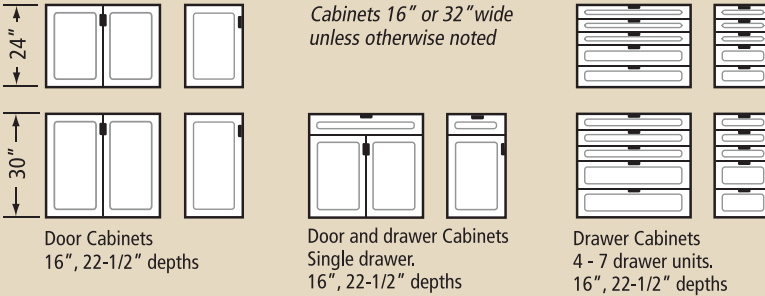

TALL STORAGE CABINETS

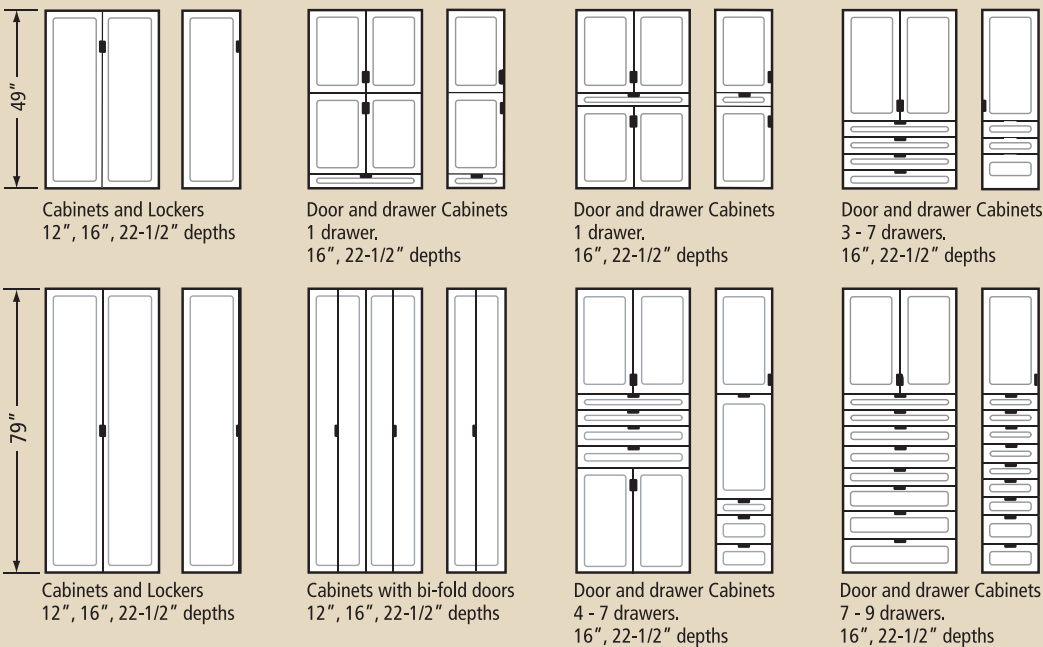

Cabinets 16" or 32" wide unless otherwise noted

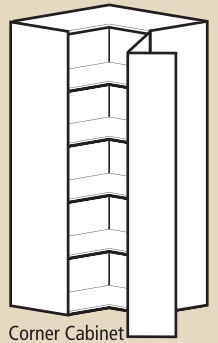

SPECIALITY CABINETS

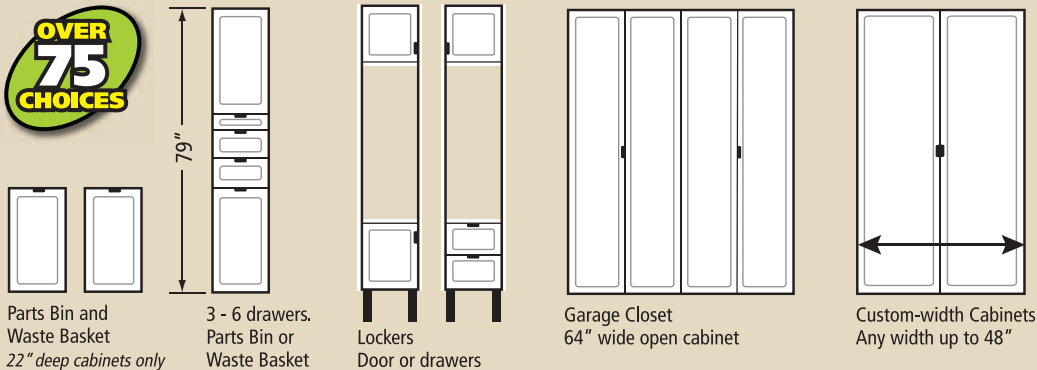

Cabinets 16" or 32" wide unless otherwise noted

Custom Island Cabinets

Island Cabinets share all the same features as our **garagegear** cabinets, but are freestanding, so they can be located anywhere, even the middle of your garage if you choose. Island Cabinets are mounted on adjustable legs, or casters, and feature finished powder-coated back panels so they look great on all sides.

Island Cabinets use the same lower cabinet drawer units, door units and bins as our regular **garagegear** cabinets (see the Cabinet Choices page to the left). Mix and match these components to create the Island Cabinet for you.

And Island Cabinets are a great complement to our wall-hung cabinets.

Island Workbench

The Island Workbench is a stationary unit featuring adjustable legs, available in 6", 32", 48", 64" or 80" widths, with a 24" deep worksurface. In addition, the 80" unit can contain a knee hole for sitting. The larger units feature additional legs for stability.

Rolling Workbench

Move your work surface, tools and equipment to your projects, with our Rolling Workbench. Large 6" rubber casters roll easily and quietly wherever you want and lock for stationary use. Available in 16", 32", 48", 64" or 80" widths.



Rolling Workbench features smooth rolling locking casters



80" cabinet is available in rolling (above) or freestanding styles



Knee hole is available only on the stationary 80" Island Workbench

WORKBENCH

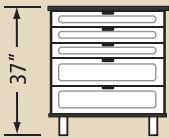

16" or 32" Workbench
Drawer or door units
24" depth

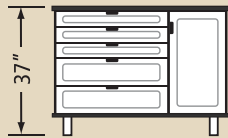

48" or 64" Island Workbench
Mix drawer and door units
24" depth

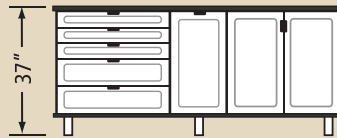

80" Island Workbench
Mix drawer and door units
24" depth



80" Island Workbench
Drawer and door units with knee hole
24" depth

ROLLING ISLAND

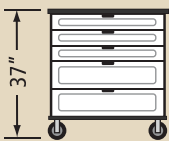

16" or 32" Rolling
Drawer or door units
24" depth

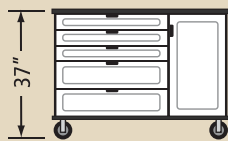

48" or 64" Rolling Workbench
Mix drawer and door units
24" depth

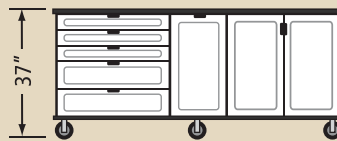

80" Rolling Workbench
Mix drawer and door units
24" depth



Additional Storage Options

Slatwall

StoreWALL® slatwall is the perfect companion for **garagegear** cabinets. Get everything from bikes to toys to garden equipment off your floor and keep them visible and in easy reach.

StoreWALL features heavy-duty interlocking panels of industrial-grade thermoplastic that are waterproof, mold and mildew resistant. Available in five colors, StoreWALL will blend beautifully with your **garagegear** cabinets.

A large variety of accessories from hooks to shelves to bins are available. Just snap them into place and you're finished. And rearranging things couldn't be much easier. Simply move your hooks and bins to different locations on your StoreWALL, and you're done.



StoreWALL will organize your tools in easy reach so you can find them quickly. Great for tools and equipment of all sizes.

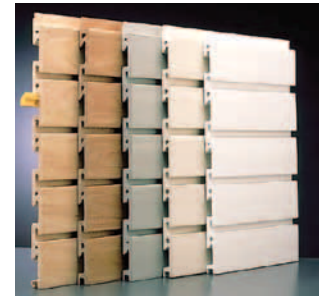

Choice of three solid colors and two wood grains

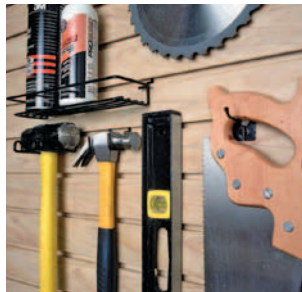

Great for keeping hand tools in easy reach.

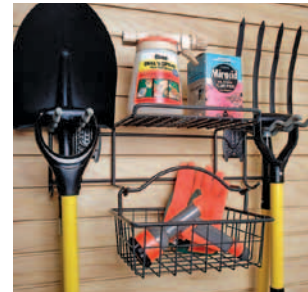

Perfect for gardening tools and supplies. Lots of hooks, bins and shelves to choose from, as well as speciality holders.



Overhead Storage Racks

Still need more storage space? Use the space over your head. Our Super-Pro ceiling storage racks are an economical way to add overhead storage. Ideal for bulky items, boxes or storage containers and out-of-season items.

Constructed of steel with a durable white finish, overhead racks feature adjustable heights to fit your space. Units are available in 4' x 4' or 4' x 8' sizes. Multiple units can be used together to increase your space as needed.



Keep sports equipment and toys off the floor, but still within easy reach when the mood strikes.

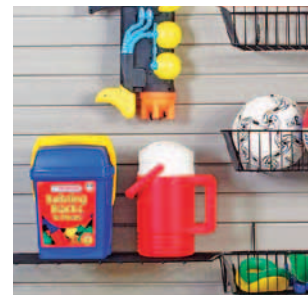

A line of heavy-duty accessories are available. They feature a CamLock locking mechanism to ensure the accessory stays put.



Make use of all those small hard-to-use spaces.



Super-Pro Ceiling Storage Rack

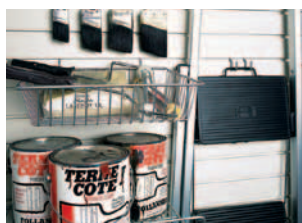

Keep all your supplies accessible and easy to find.



Heavy-duty StoreWALL will even support weight like this.



Hobbyists will enjoy speciality items for office supplies.

Getting Started

Our process is simple...at least for our customers. The entire process has been designed to minimize your effort while keeping you in control. It all starts by contacting an Authorized Agent.

Contact your local Agent

If you have a printed copy of this brochure, chances are you know your local Agent. If you don't, visit us at www.redlinegaragegear.com. Click on "Find an Agent" on the top of the home page. You'll be asked for your ZIP code so we can find an Agent in your area. You'll be forwarded to your local Agent's web page where you'll find contact information. Simply call or email.

Consultation

Once you've contacted your Agent, he or she will set up an appointment to discuss your needs and budget, and to get specific information on the space you need organized. This initial consultation takes about an hour or so, depending on your project, and your goals.

Design and Proposal

Based on the information you provide, a design will be created specifically for your requirements. All designs are custom, since no two garages or needs

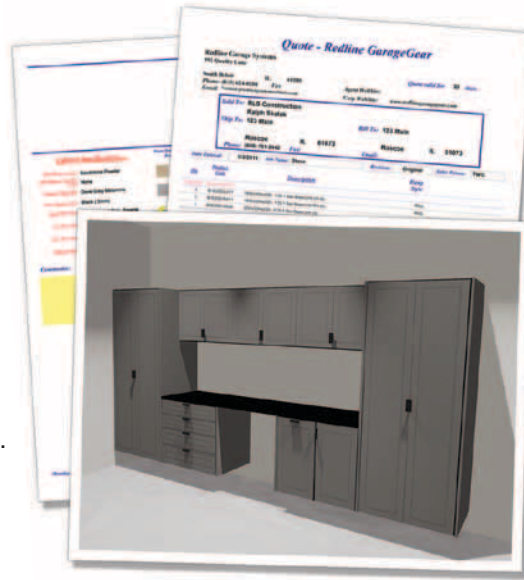

are the same. In a couple of days you'll receive a detailed written quote and a 3-D drawing of the proposed design. Once you've settled on a design, our work begins.

Manufacturing

Designs and specifications are sent directly to our factory, where your garage cabinets will be custom manufactured. Our facilities are state-of-the-art, ensuring your finished cabinets meet our exacting quality standards. In a week or so, your product will ship directly to your home for installation

Installation

Final installation usually takes only a day or two depending on the size of your project. Now it's up to you to fill your new cabinets and enjoy your new organized space.

About RedLine Agents

RedLine **garagegear** is sold and installed only by Authorized Agents. Our Agents are factory trained and certified in the proper handling and installation of all **garagegear** products. You can be sure everything will work properly and stay that way.

Agents are assigned regional territories, so you will always be dealing with the same people. They'll want you to be satisfied, and so do we!



Garagegear Warranty

RedLine Cabinets with a powder-coated finish are guaranteed to function normally for a lifetime when installed by an Authorized RedLine Agent. Covered items include cabinet doors, work surfaces, pulls, hinges, castors and glides.

To qualify, cabinets must be the original, unmodified installation and in the possession of the original owner.

Minor scratches, dents, nicks, and scuffs are normal wear and are not covered. Deliberate or excessive abuse is not covered.

See your Authorized Agent for complete warranty details.

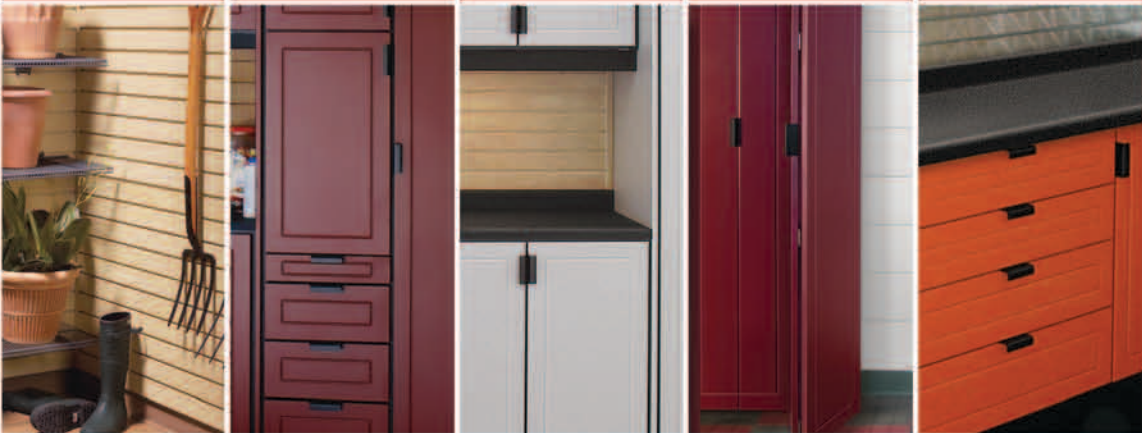

www.redlinegaragegear.com

Authorized Agent:

in the garage

Greater Quad-Cities - Ryan Peterson
inthegarageqc@gmail.com - 563.265.1898
Greater Dubuque - Tim Jeske
inthegaragedbq@gmail.com - 563.580.6955
www.inthegarageonline.com

Corporate Office: 877/624-2332